

Zakres podstawowy

os. Zielone wzdłuż budynku nr 7 (dz. 57/1, obr. NH-45)

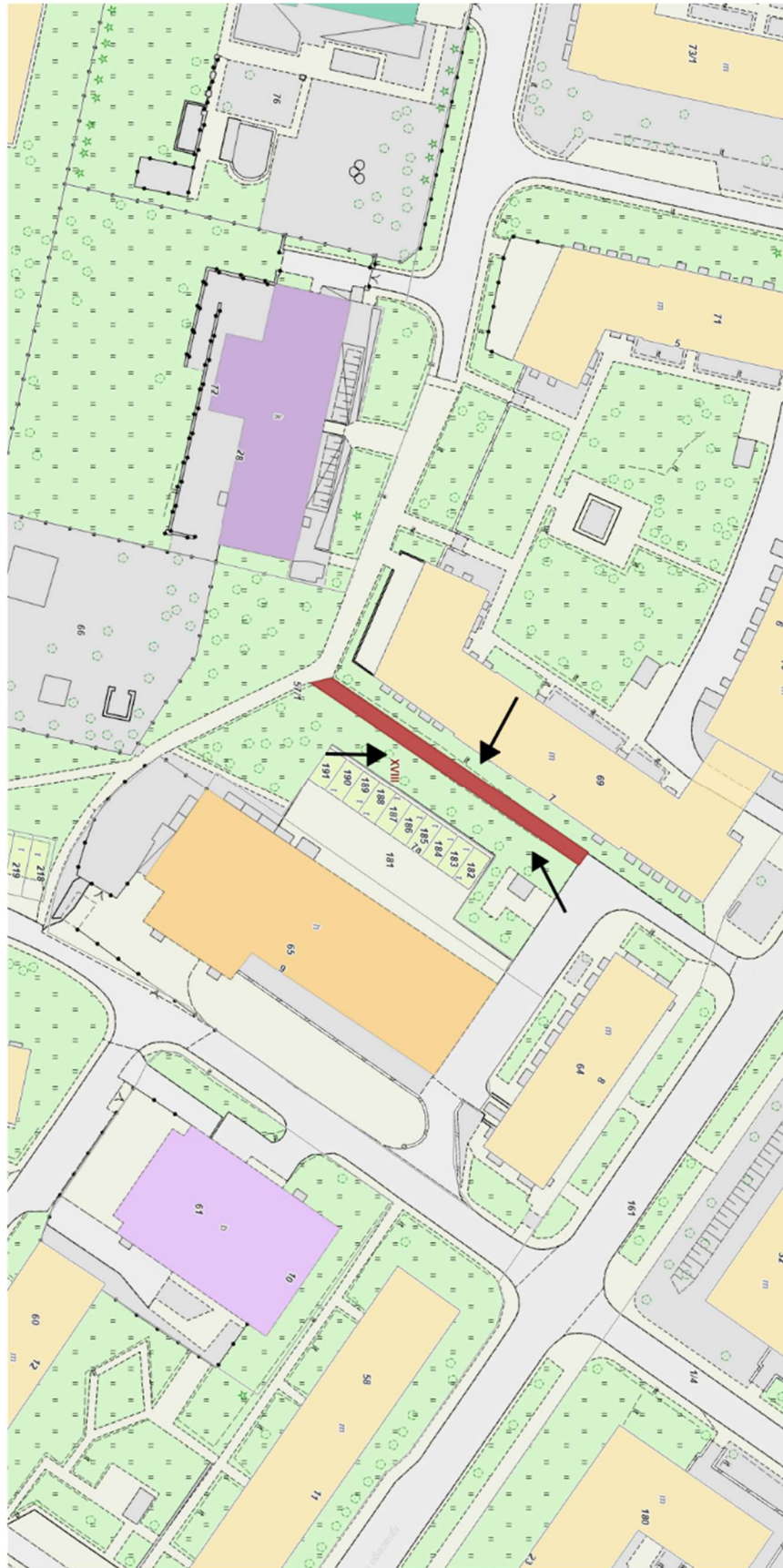

os. Zielone w stronę ogródka Jordanowskiego (dz. 57/1, obr. NH-45)

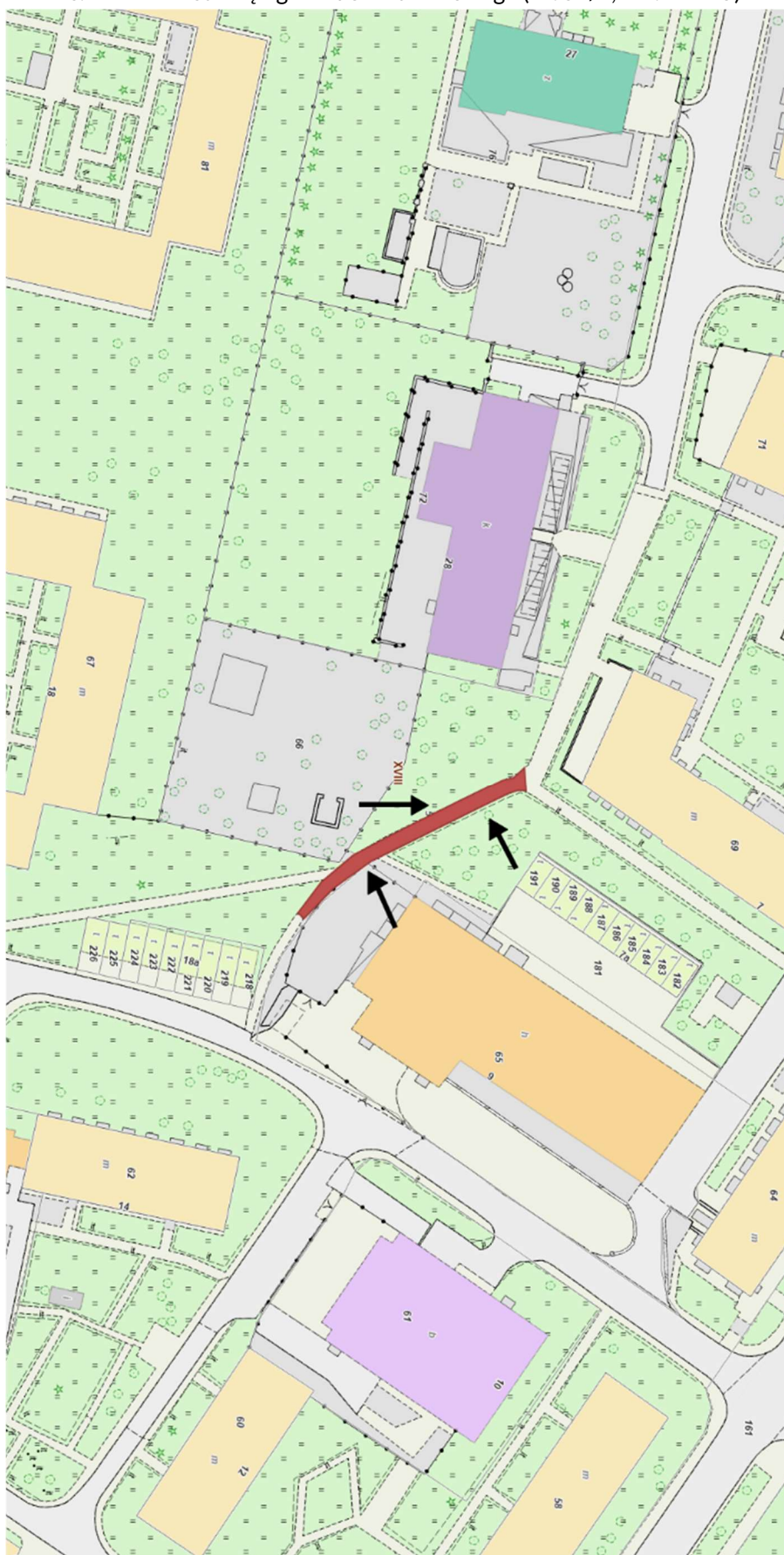

os. Sportowe 24 - remont chodników przed budynkiem (dz. 1/4 obr. NH-45)

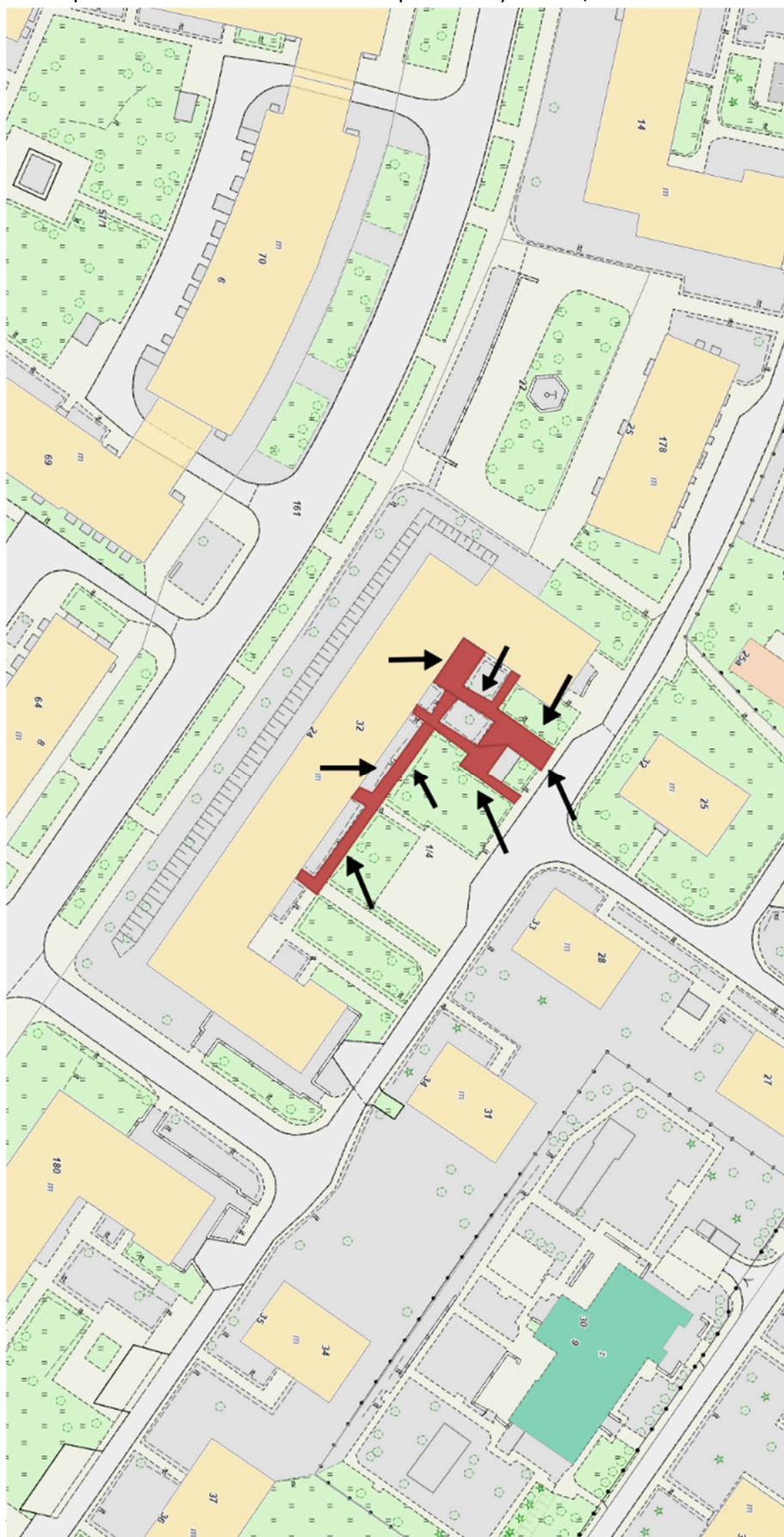

os. Centrum C 10 w rejonie ogródka Jordanowskiego – (dz. 182/2, obr. NH-50).

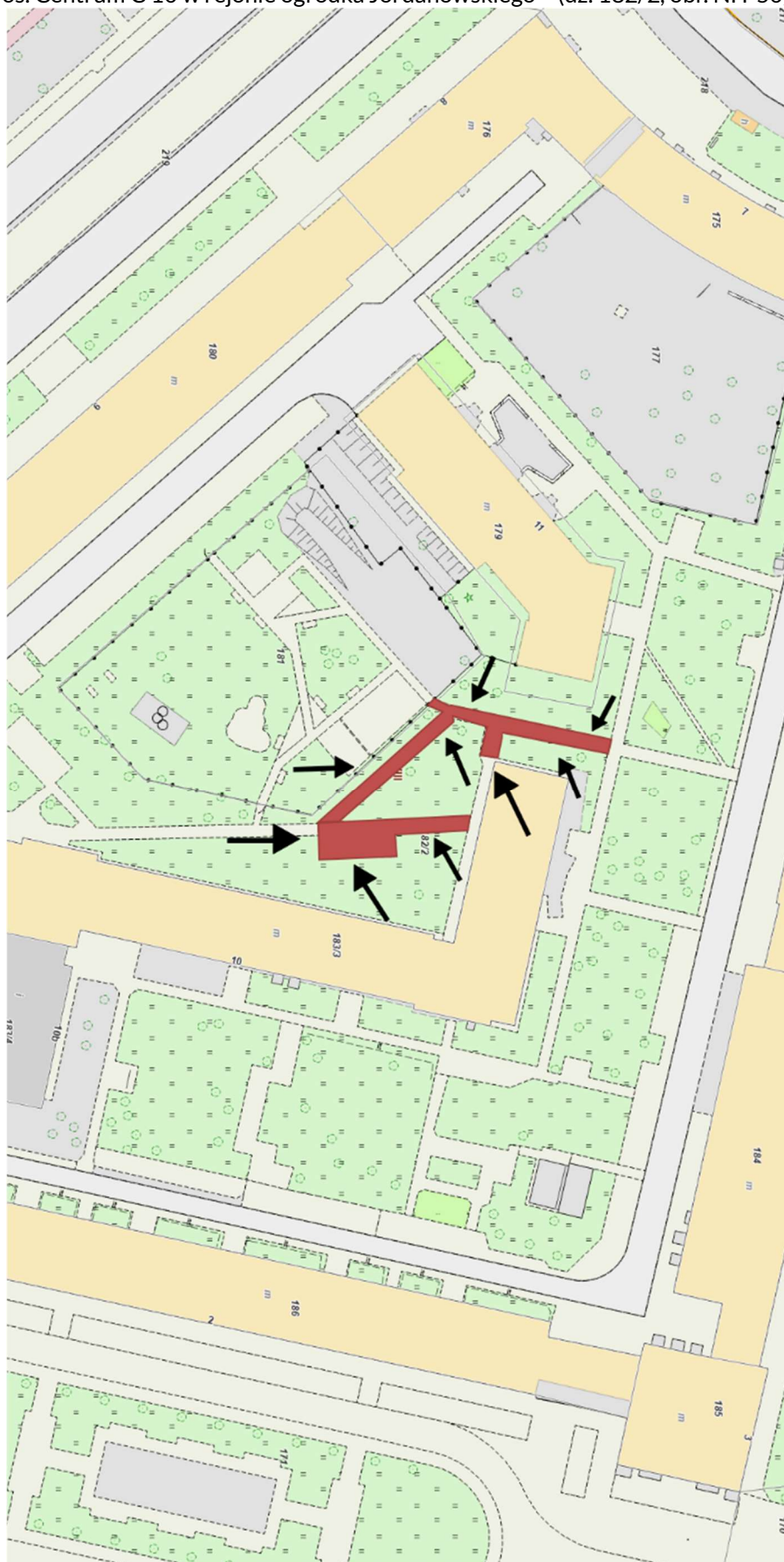

os. Teatralne 21 do 24 (dz. 55/4, 93/4, obr. NH-50)

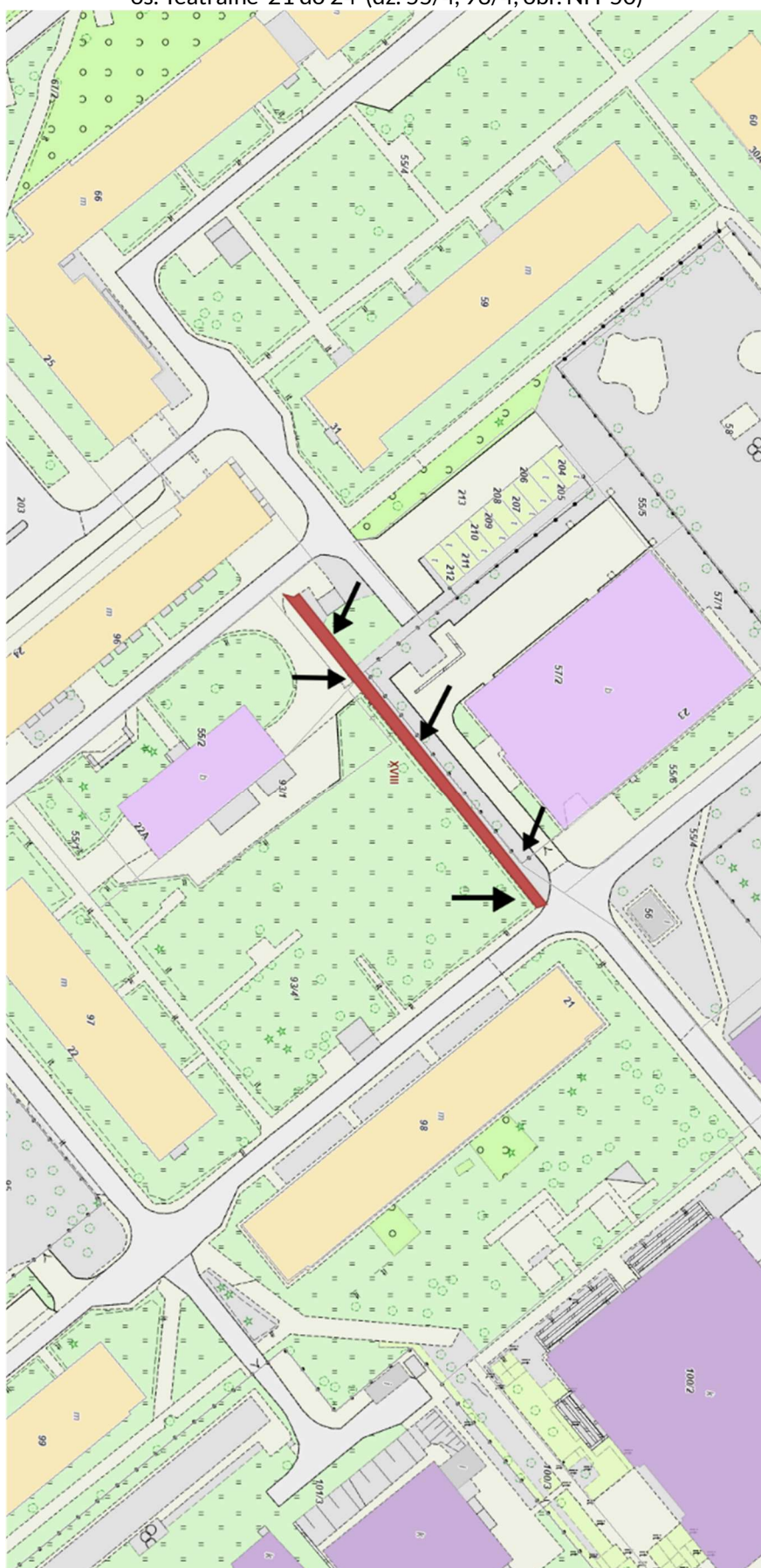

os. Sportowe 1 a 13 (dz. 1/4, 93/4, obr. NH-45)

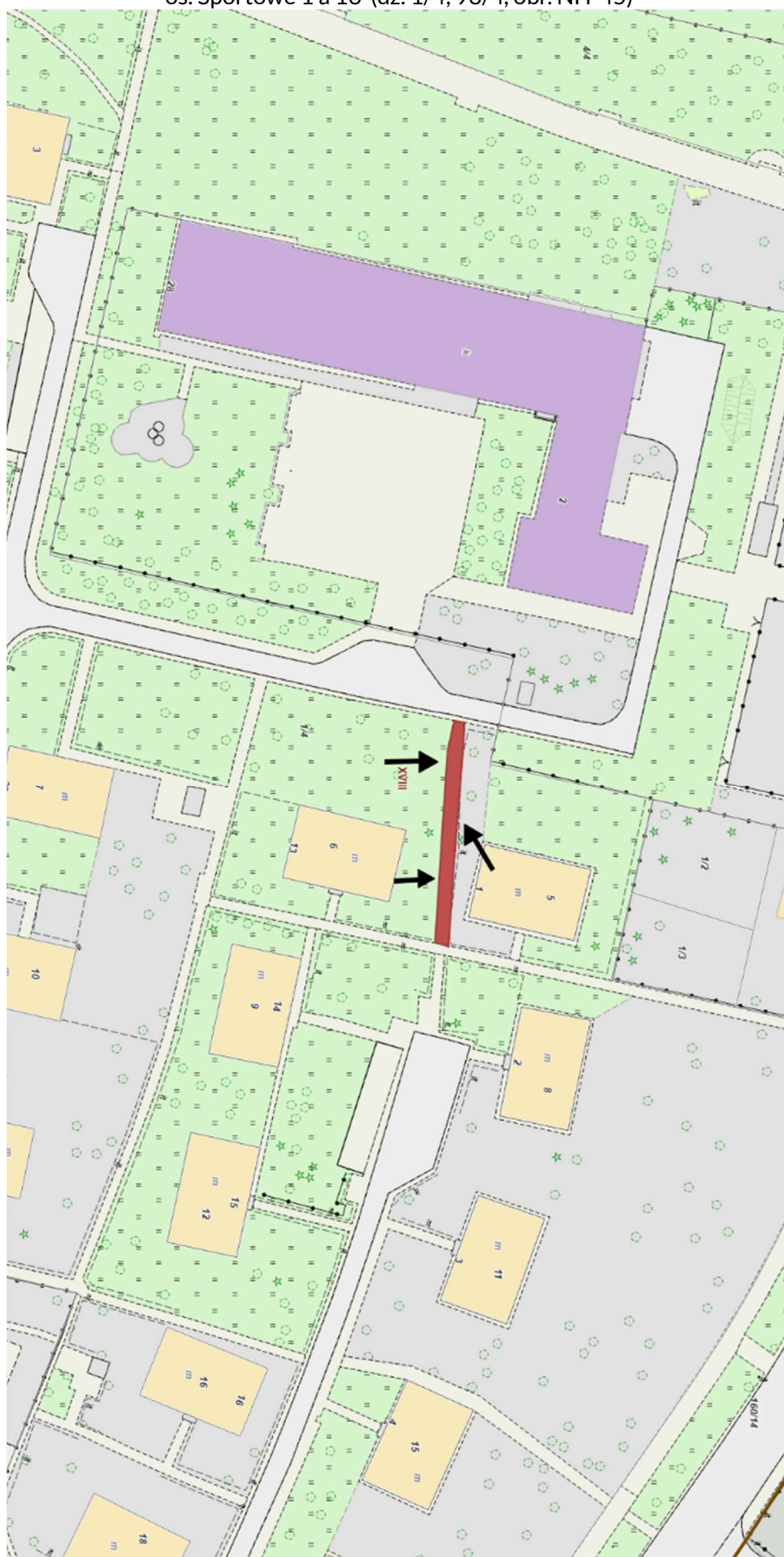

os. Urocze - w rejonie bloków 7,8 (dz. 134/2, obr. NH-50)

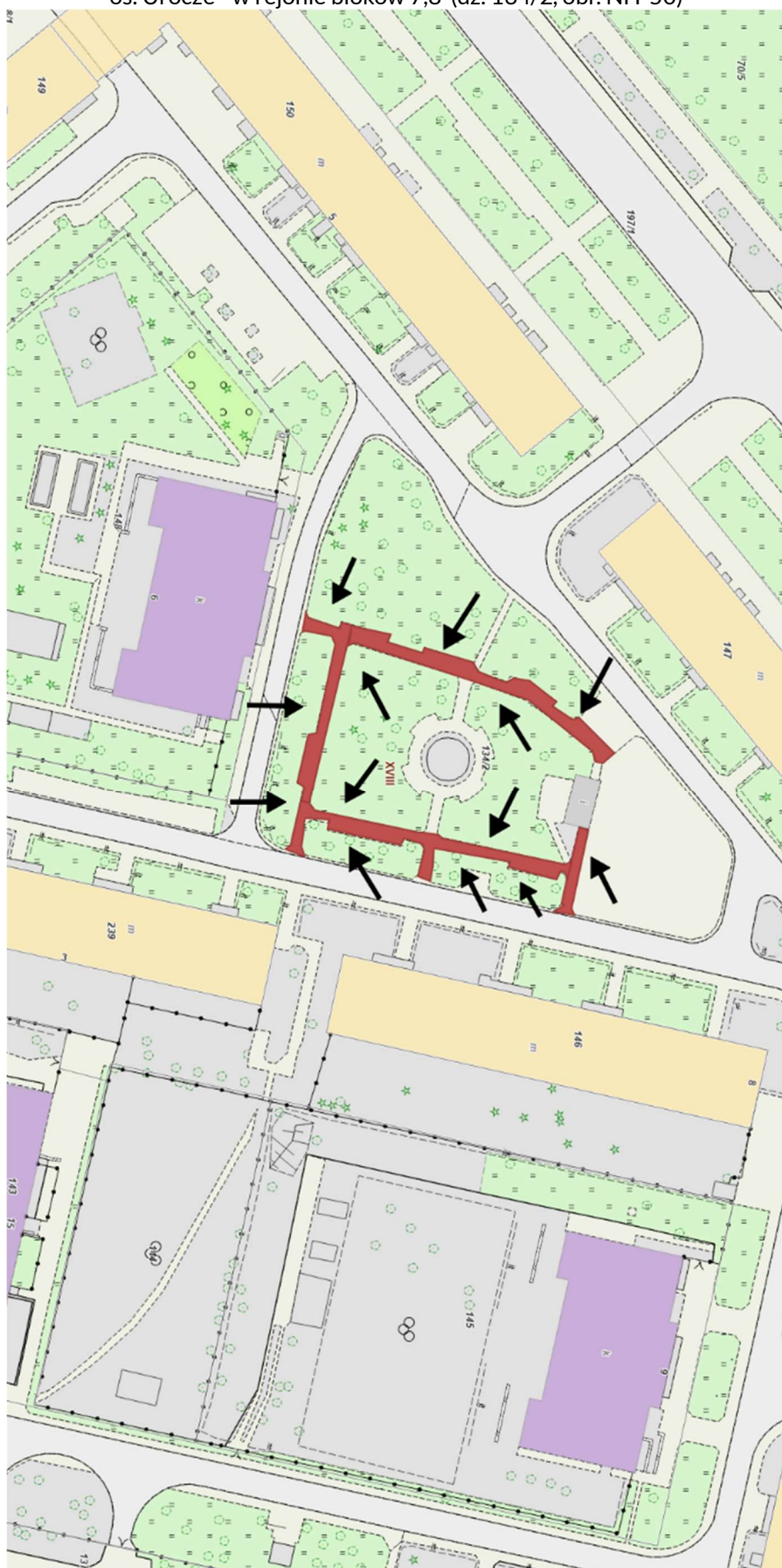

Zakresy objęte prawem opcji

OPCJA 1 – os. Centrum C 10 wzdłuż ogrodzenia i bloku nr 10 (dz. 182/2, obr. NH-50)

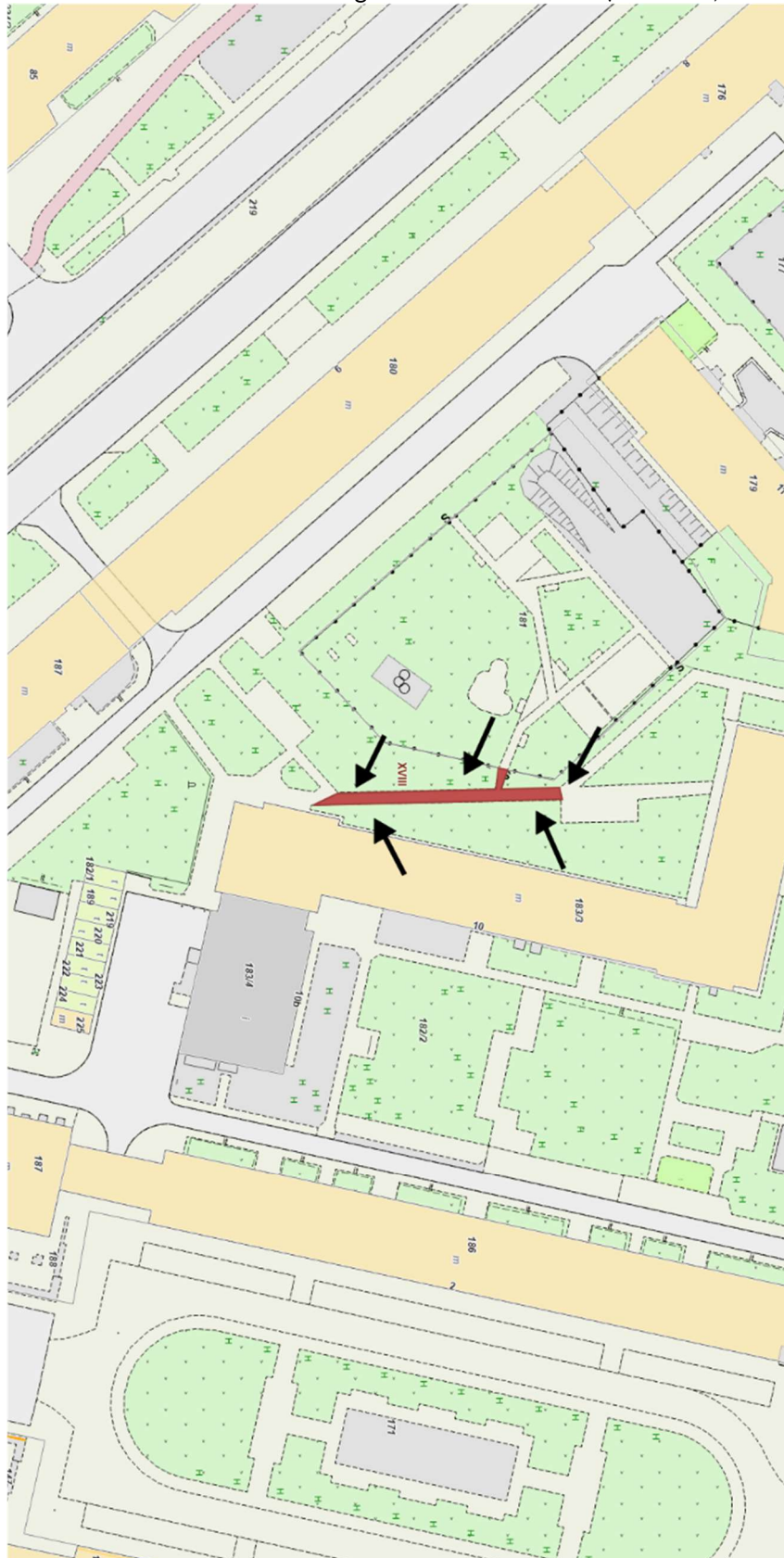

OPCJA 2 – os. Centrum C 10 – od strony budynku nr 9 (dz. 182/2, obr. NH-50)



OPCJA 3 – os. Centrum C 10 – od strony budynku nr 1 (dz. 182/2, obr. NH-50)

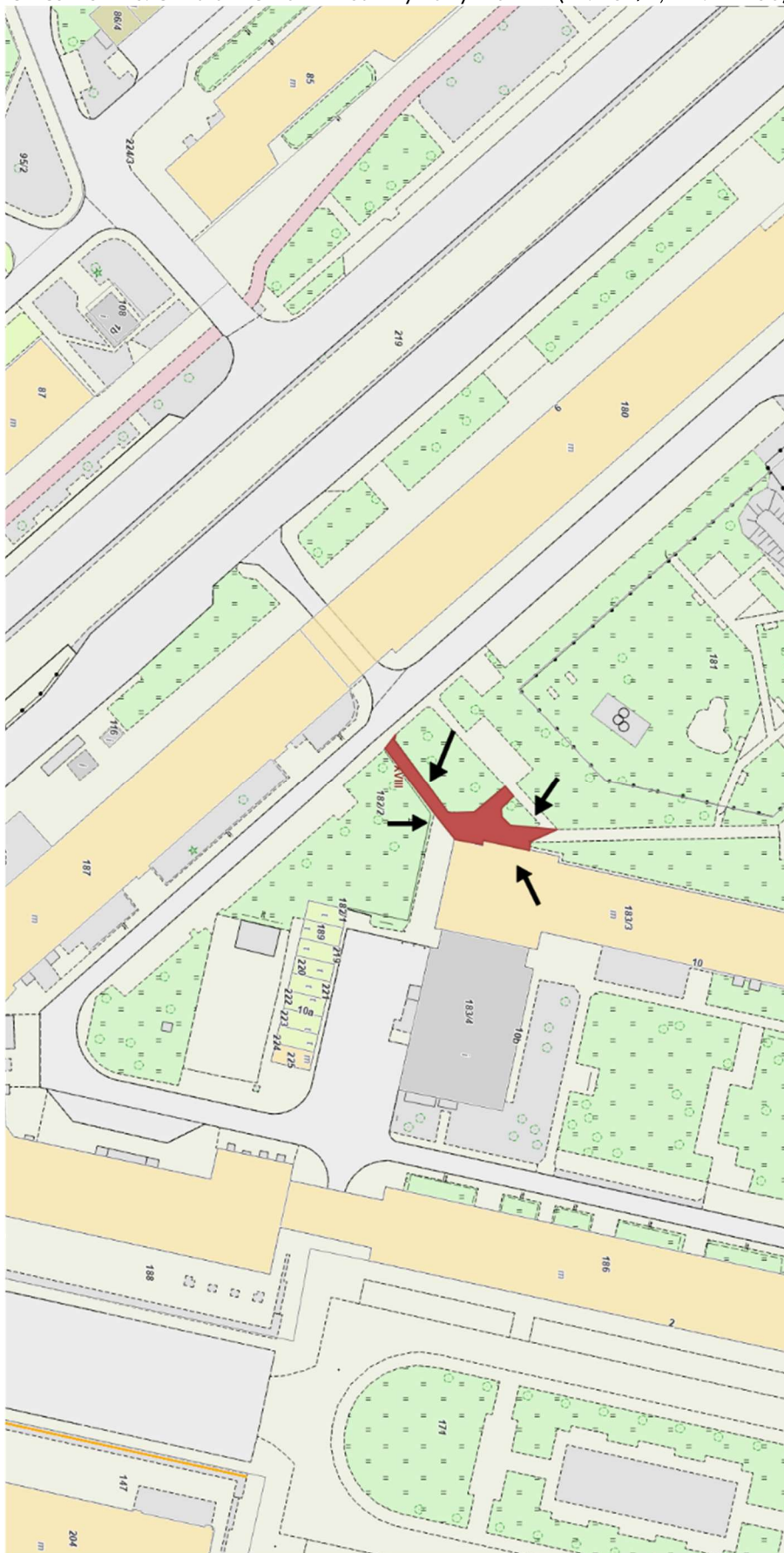

OPCJA 4 – os. Centrum C 10 – wzdłuż ściany szczytowej (dz. 182/2, obr. NH-50)

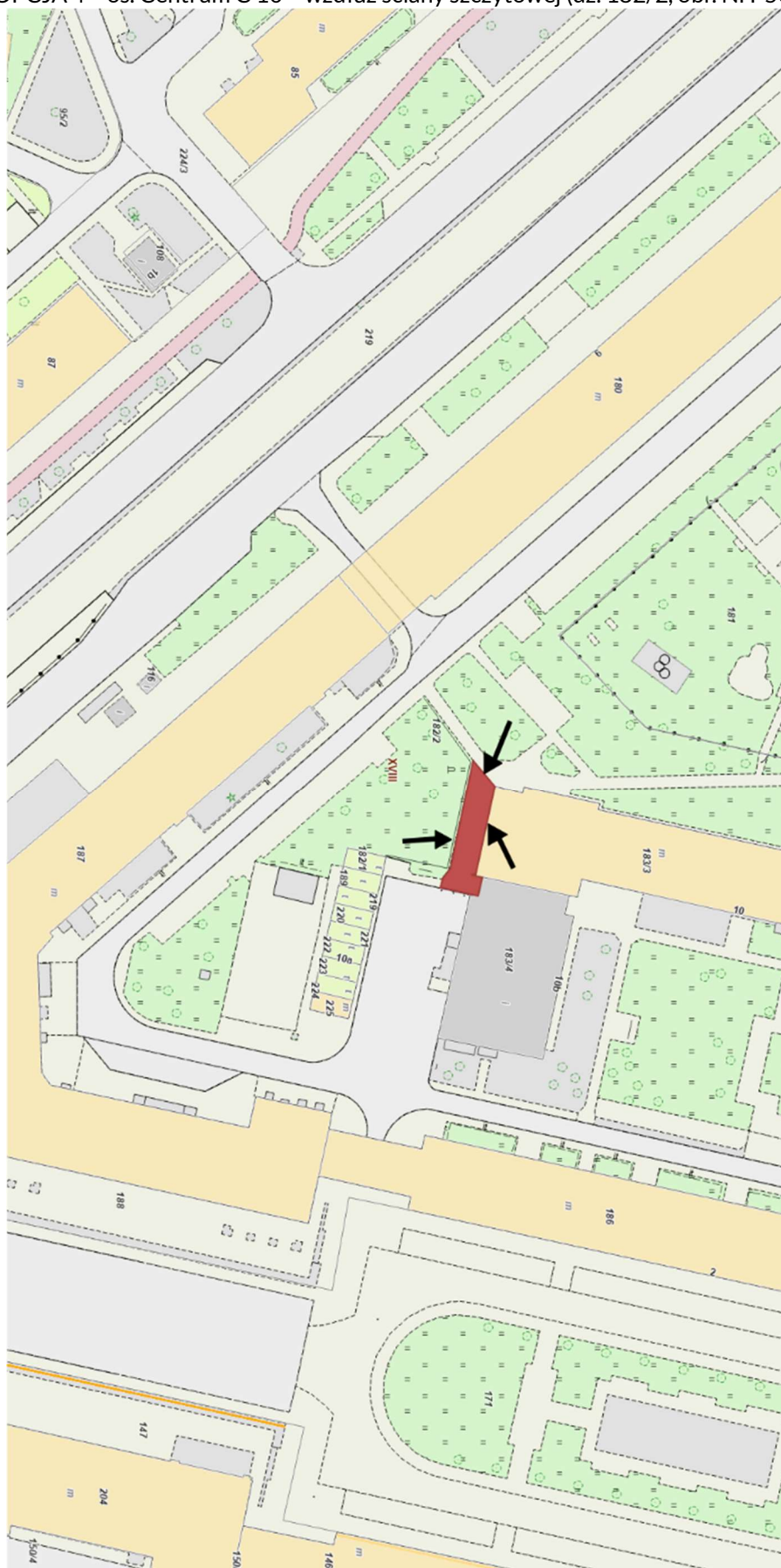

OPCJA 5 – os. Centrum A - i 6 a 14 (dz. 2/1, obr. NH-47)

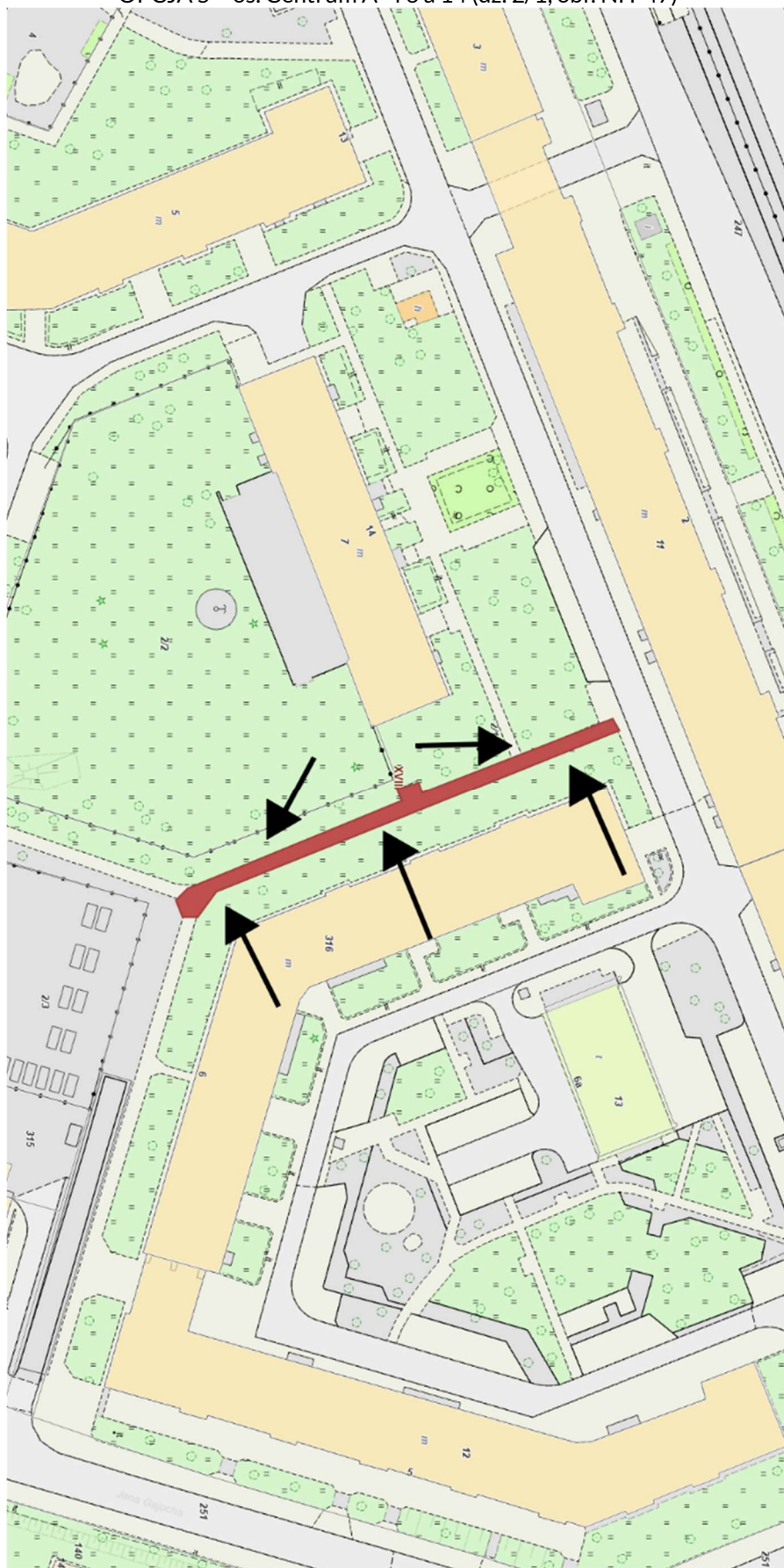

OPCJA 6 – os. Na Skarpie 26 (dz. 176/4, obr. NH-47)

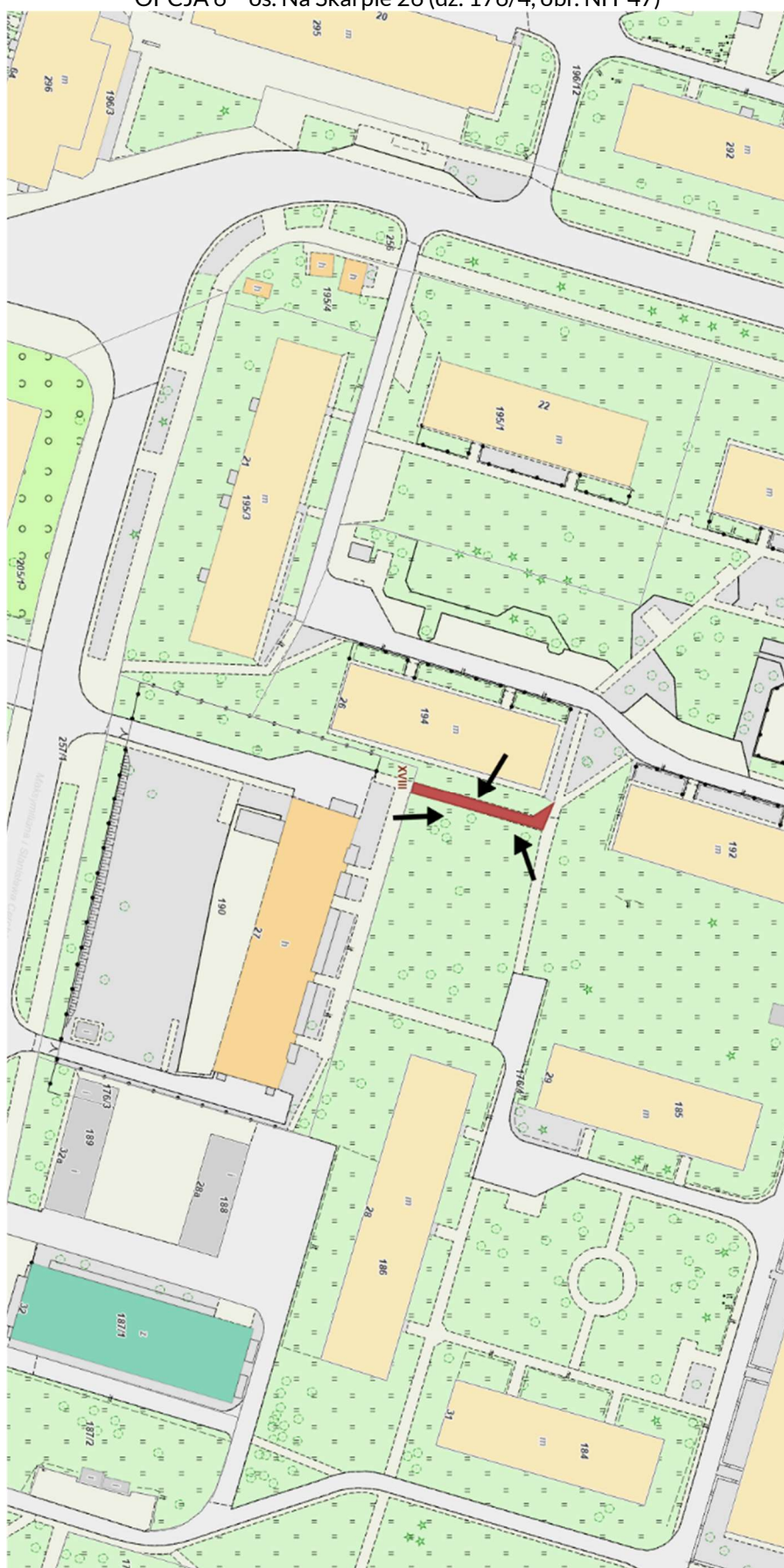

OPCJA 7 – os. Na Skarpie 29(dz. 176/4, obr. NH-47)

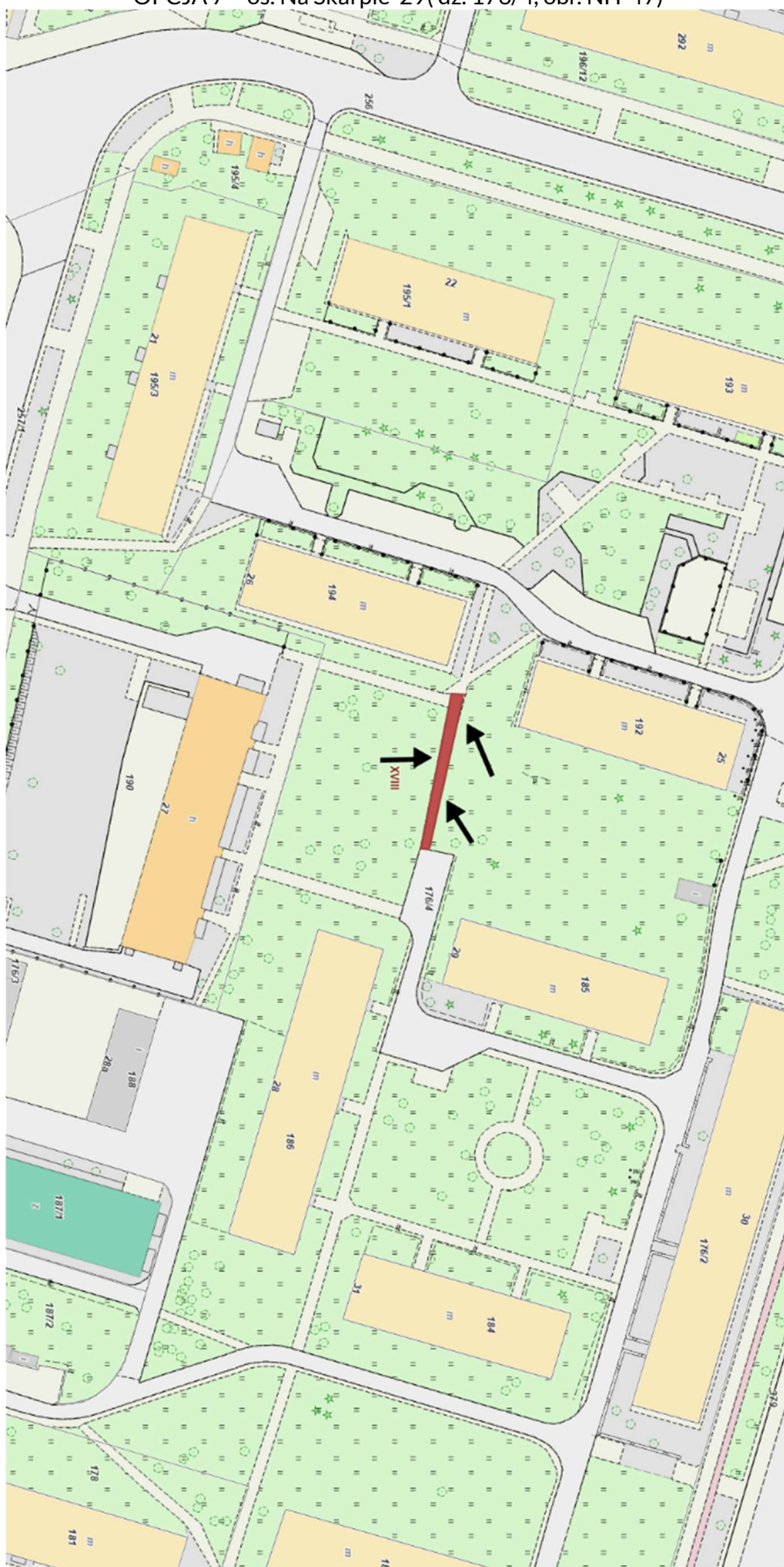

This aerial map shows a residential development with various building footprints, parking lots, and landscaping. A red line labeled 'XVII' with arrows indicates a proposed access point between two parking areas. The map includes numerous lot numbers and building footprints, such as 1954, 1957, 1984, 192, 185, 184, 183, 177, 188, 187, 178, 1764, 1727, 1712, 1707, 169, 168, 160, 159, 158, 157, 156, 155, 154, 153, 152, 151, 150, 149, 148, 147, 146, 145, 144, 143, 142, 141, 140, 139, 138, 137, 136, 135, 134, 133, 132, 131, 130, 129, 128, 127, 126, 125, 124, 123, 122, 121, 120, 119, 118, 117, 116, 115, 114, 113, 112, 111, 110, 109, 108, 107, 106, 105, 104, 103, 102, 101, 100, 99, 98, 97, 96, 95, 94, 93, 92, 91, 90, 89, 88, 87, 86, 85, 84, 83, 82, 81, 80, 79, 78, 77, 76, 75, 74, 73, 72, 71, 70, 69, 68, 67, 66, 65, 64, 63, 62, 61, 60, 59, 58, 57, 56, 55, 54, 53, 52, 51, 50, 49, 48, 47, 46, 45, 44, 43, 42, 41, 40, 39, 38, 37, 36, 35, 34, 33, 32, 31, 30, 29, 28, 27, 26, 25, 24, 23, 22, 21, 20, 19, 18, 17, 16, 15, 14, 13, 12, 11, 10, 9, 8, 7, 6, 5, 4, 3, 2, 1. The map also shows a road labeled '157/1' and a road labeled '157/2'. The map is oriented with North at the top.