

Projekt architektury wnętrz  
realizowany w ramach projektu „Welcome to Poland”  
Uniwersytet Rolniczy im. H. Kołłątaja w Krakowie

Marta Moryń  
MoMa concept  
ARCHITEKTURA WNEŹTRZ

NIP: 9492097919  
ul. Kirkusowa 6m34  
30-440 Kraków  
tel: 881 430 984



Projekt architektury wnętrz  
realizowany w ramach projektu „Welcome to Poland”  
Uniwersytet Rolniczy im. H. Kołłątaja w Krakowie

część I

SALA 114



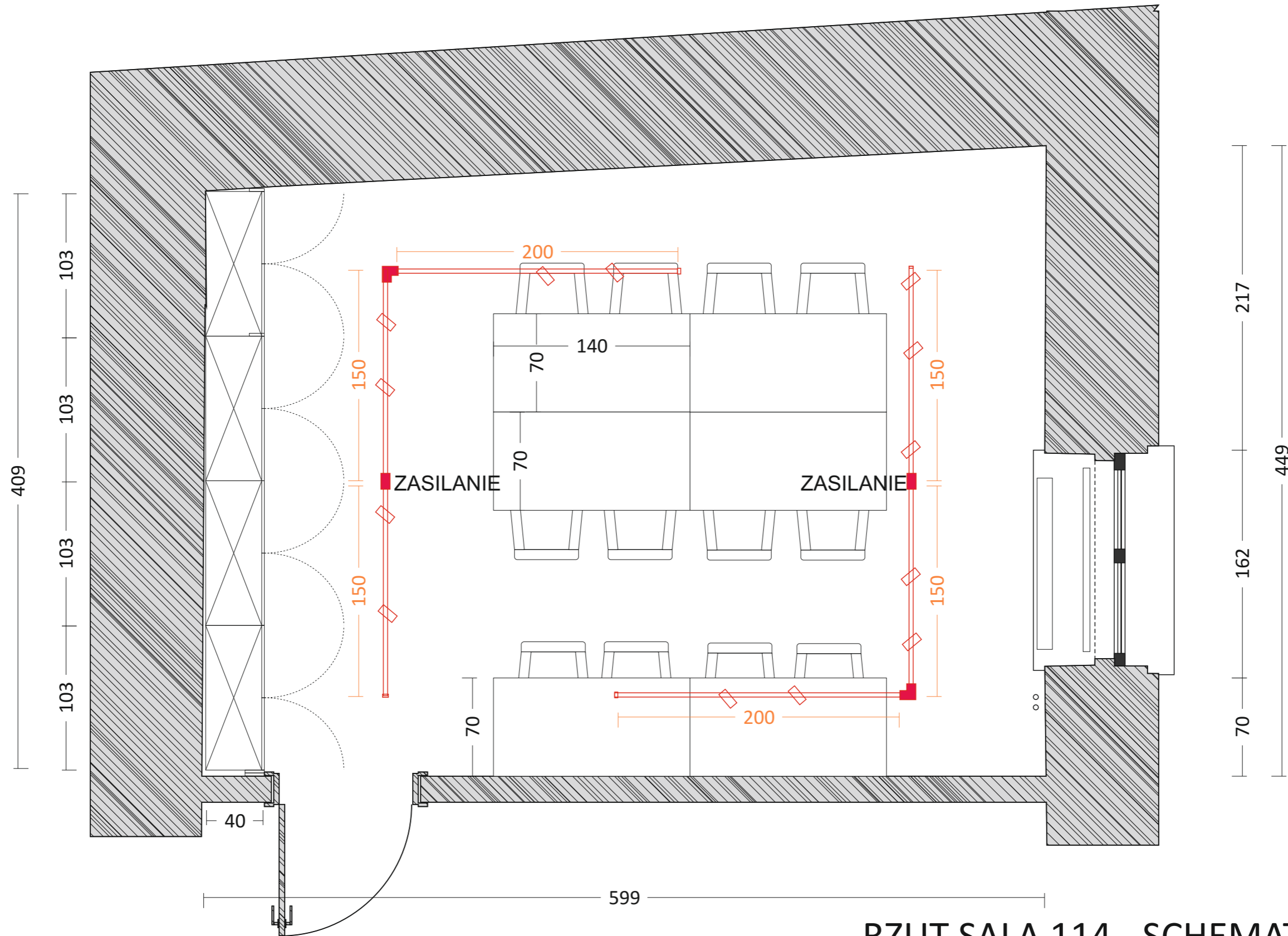

**RZUT SALA 114 - SCHEMAT ELEKTRYKI**  
skala 1:30

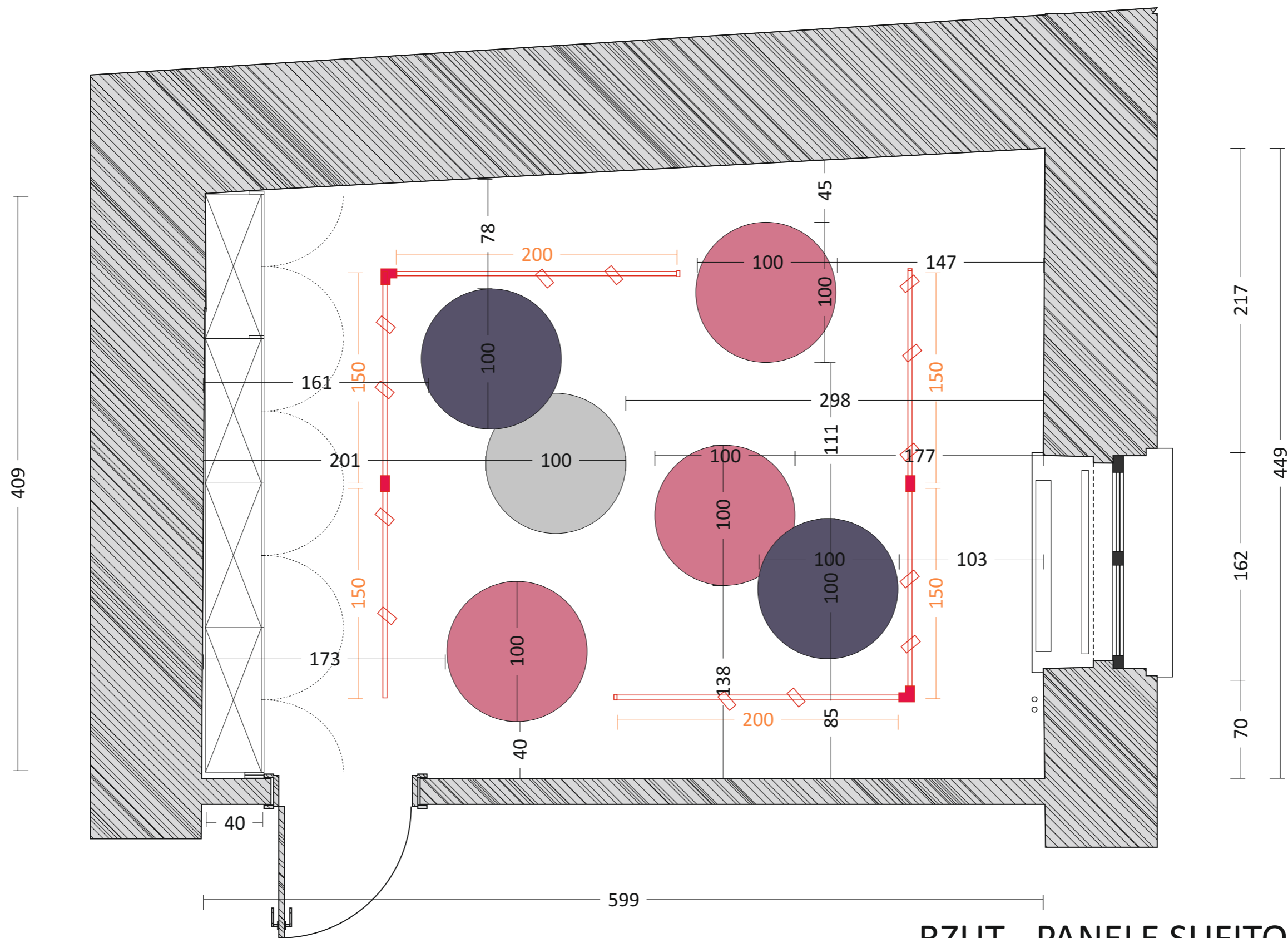

RZUT - PANELE SUFITOWE



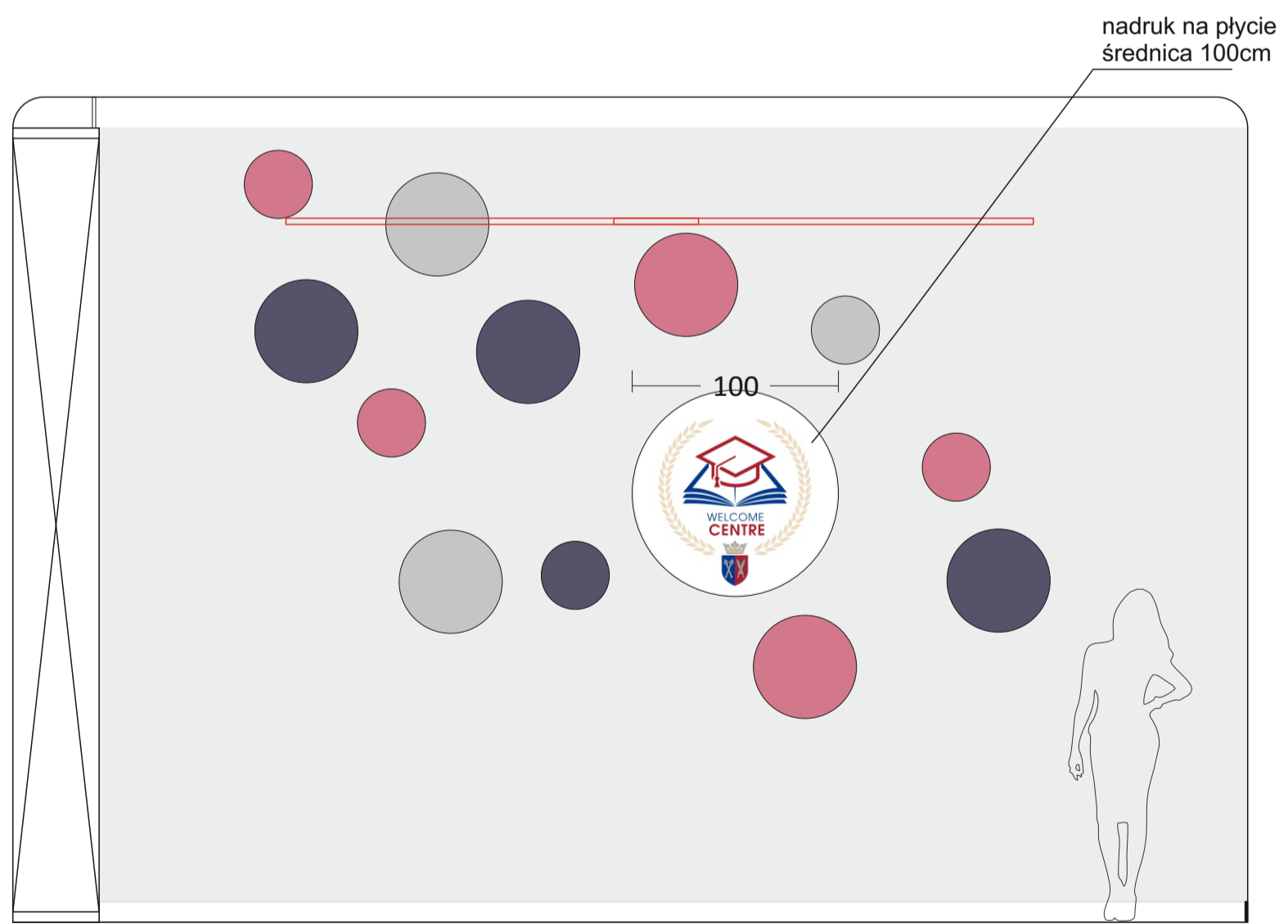
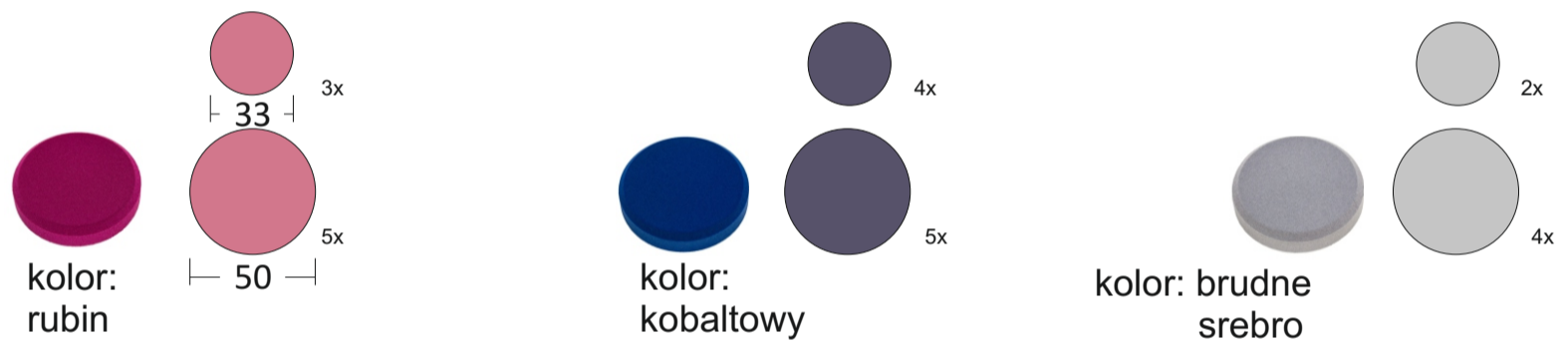
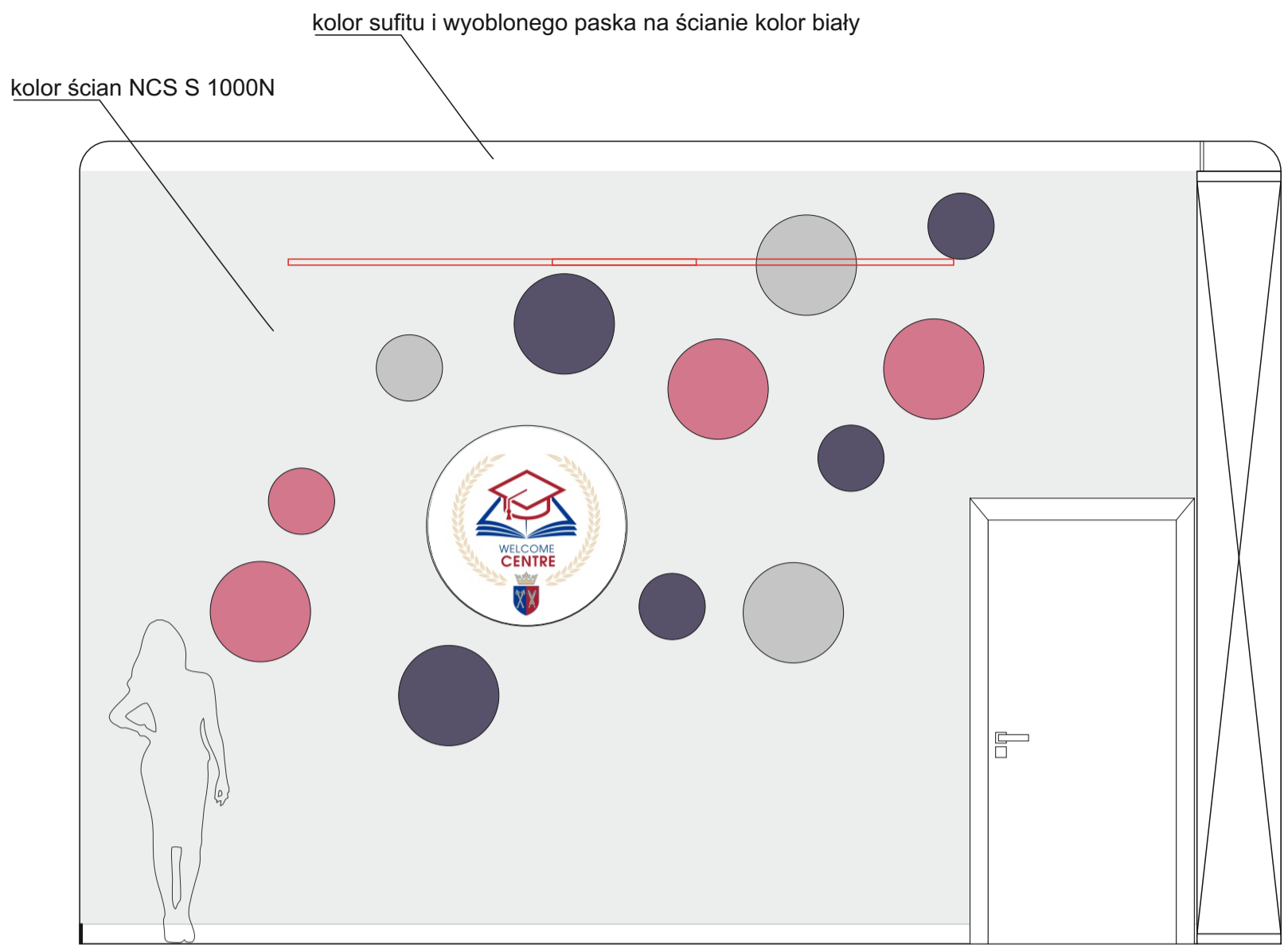

# RZUT - PANELE ŚCIENNE

skala 1:30

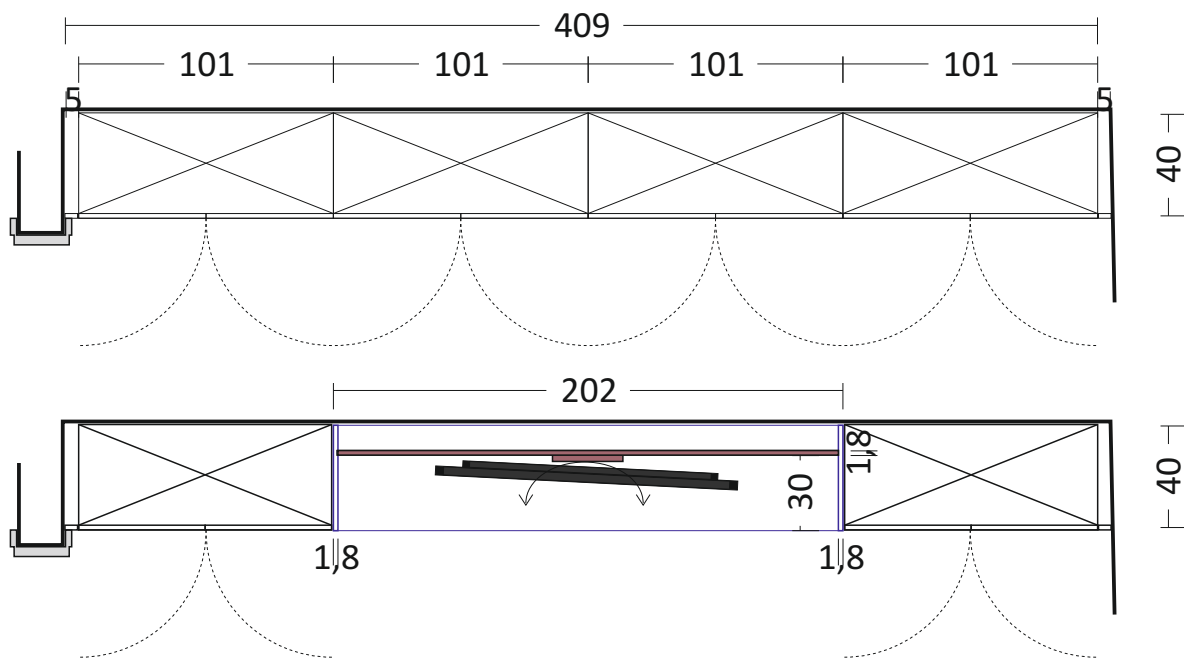
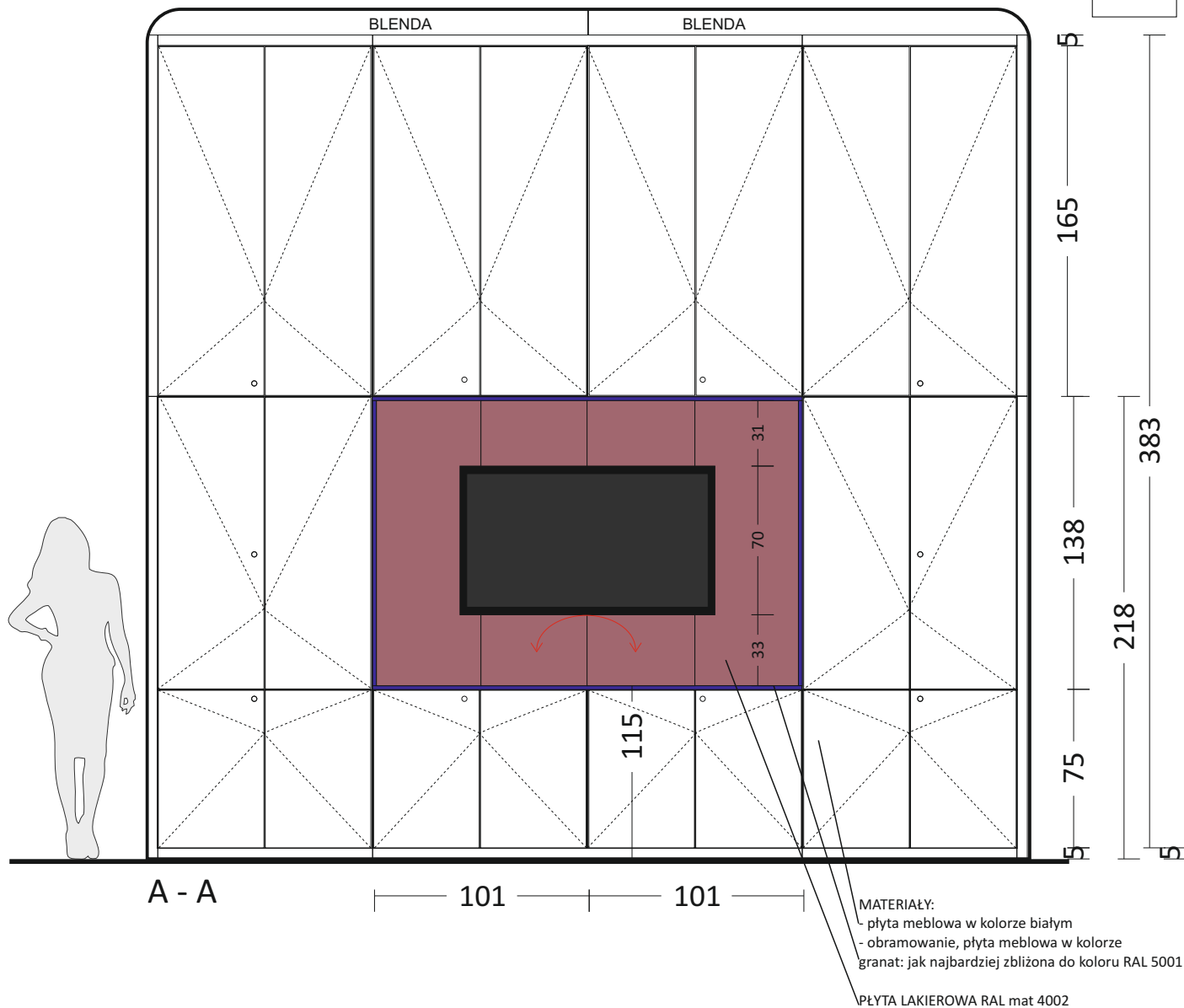

**ZAMYKANA SZAFKA NA DOKUMENTY**  
 skala 1:30



Projekt architektury wnętrz  
realizowany w ramach projektu „Welcome to Poland”  
Uniwersytet Rolniczy im. H. Kołłątaja w Krakowie

## część II

### SALA POD SCHODAMI





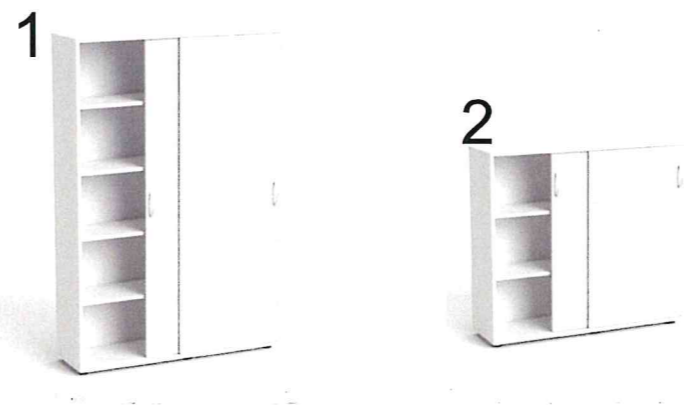
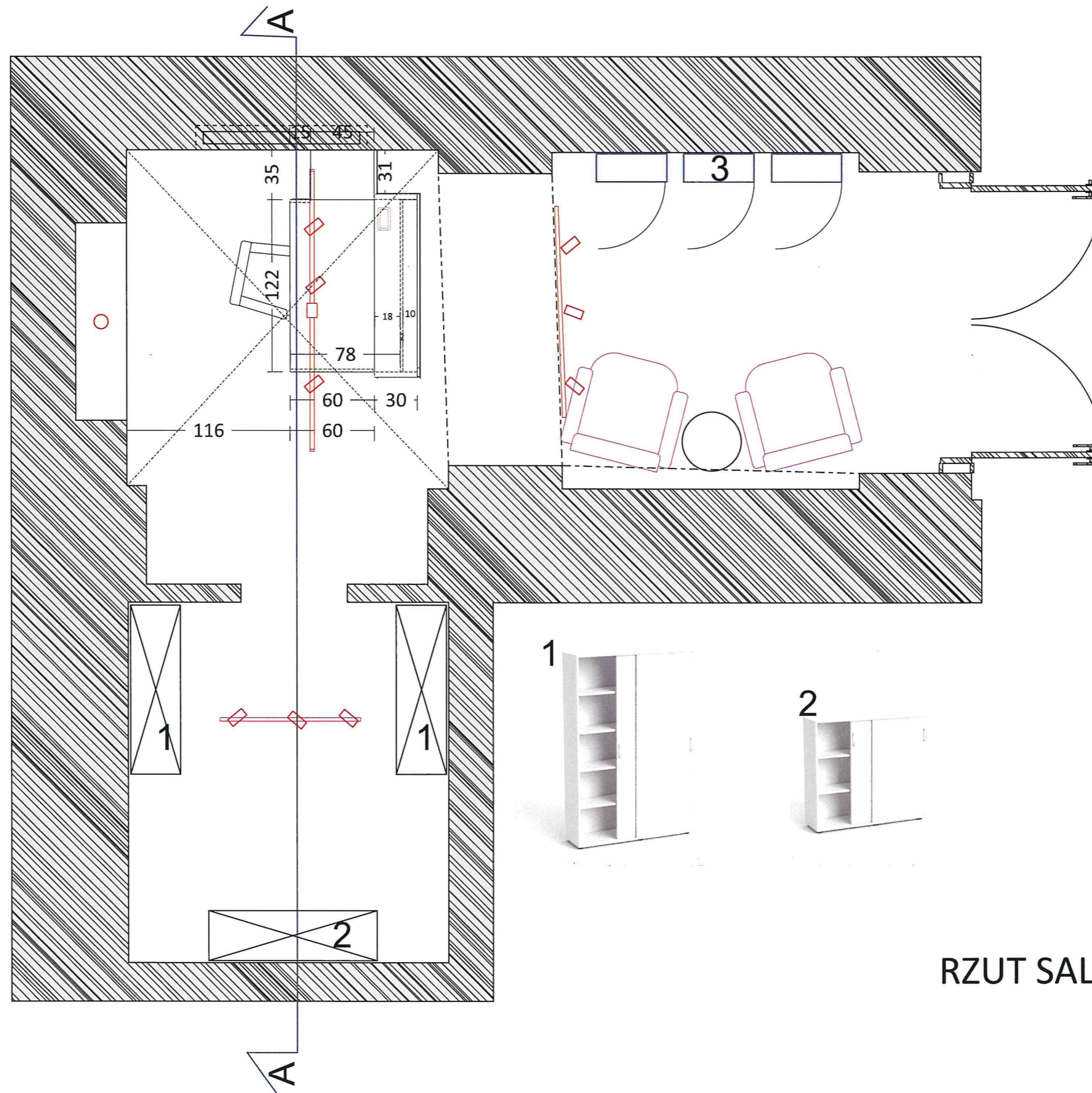

**RZUT SALA POD CHODAMI**  
skala 1:30

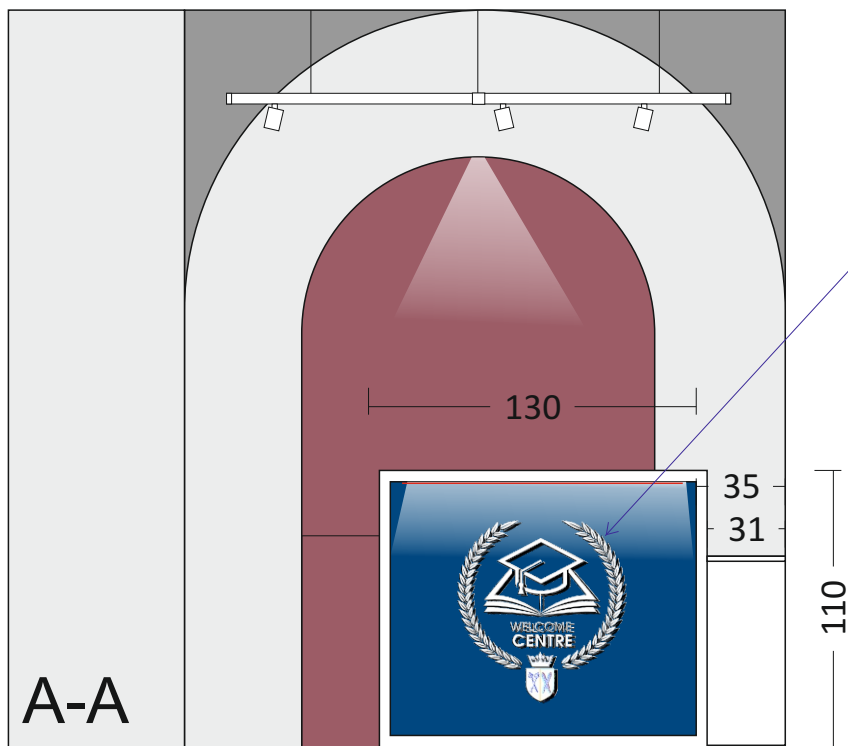

litery 3d  
 w kolorze białym

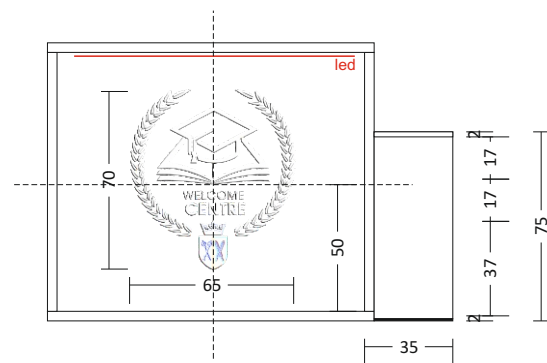

- MATERIAŁY:**
- płyta meblowa w kolorze białym
  - led o neutralnej barwie
  - power port kolor biały
  - front - płyta lakierowana na kolor RAL 5001 mat

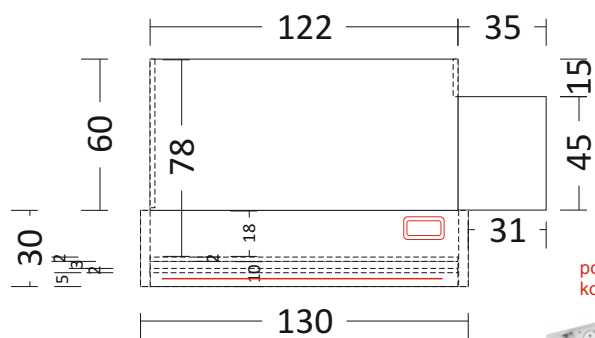

power port  
 kolor biały

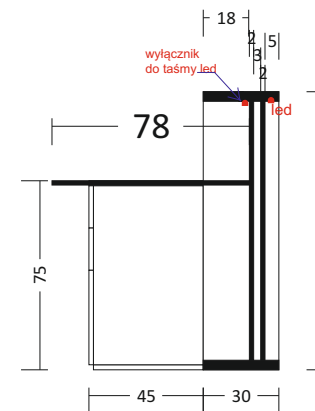
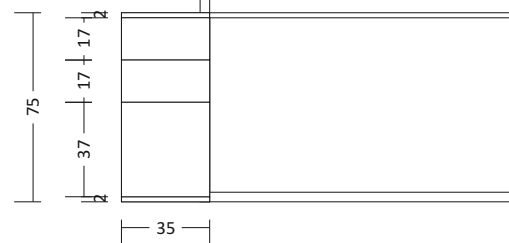

**PROJEKT BIURKA**  
 skala 1:30

# A-A

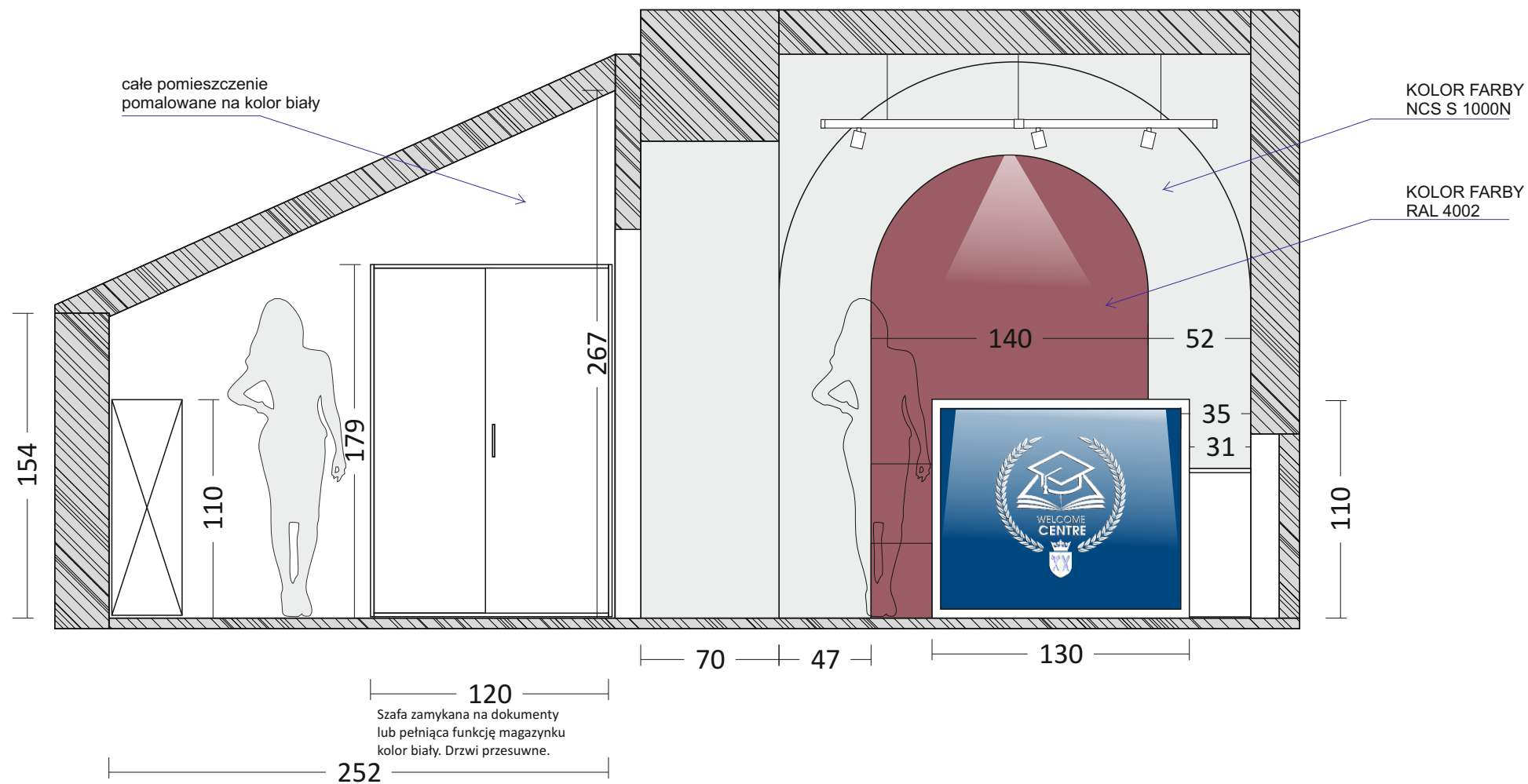

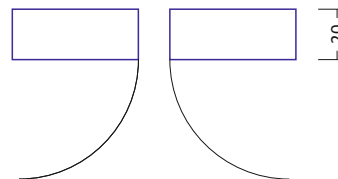
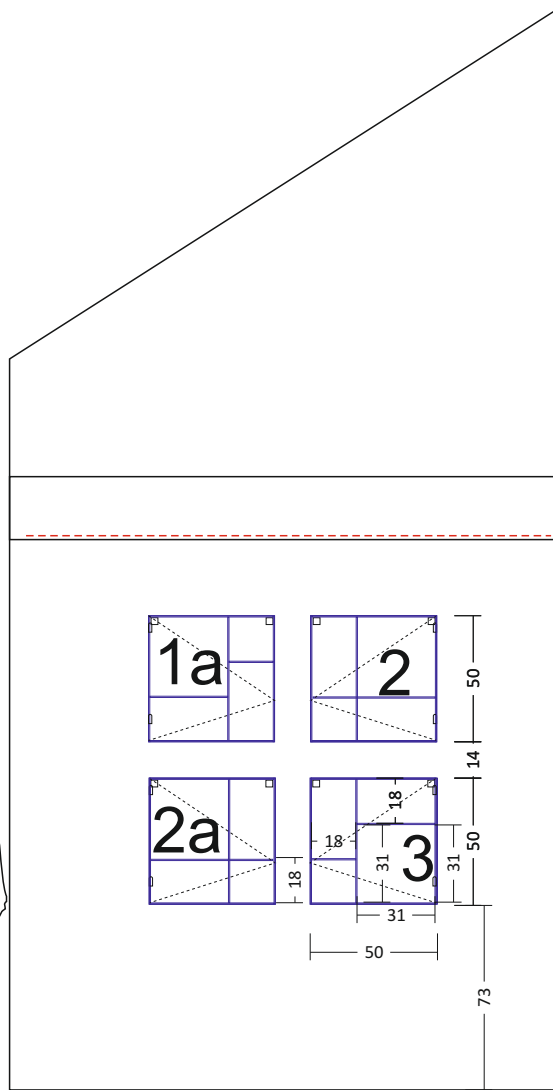
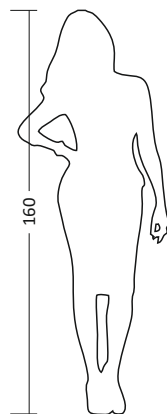
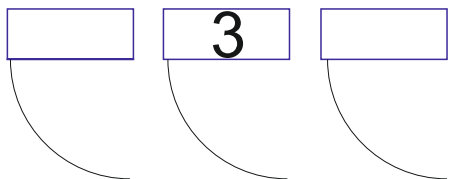
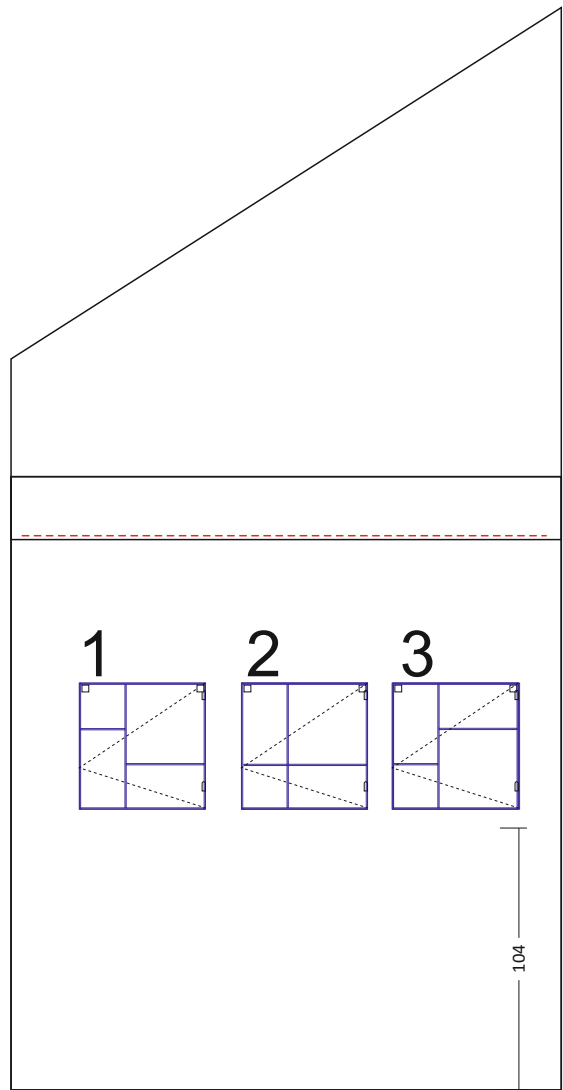



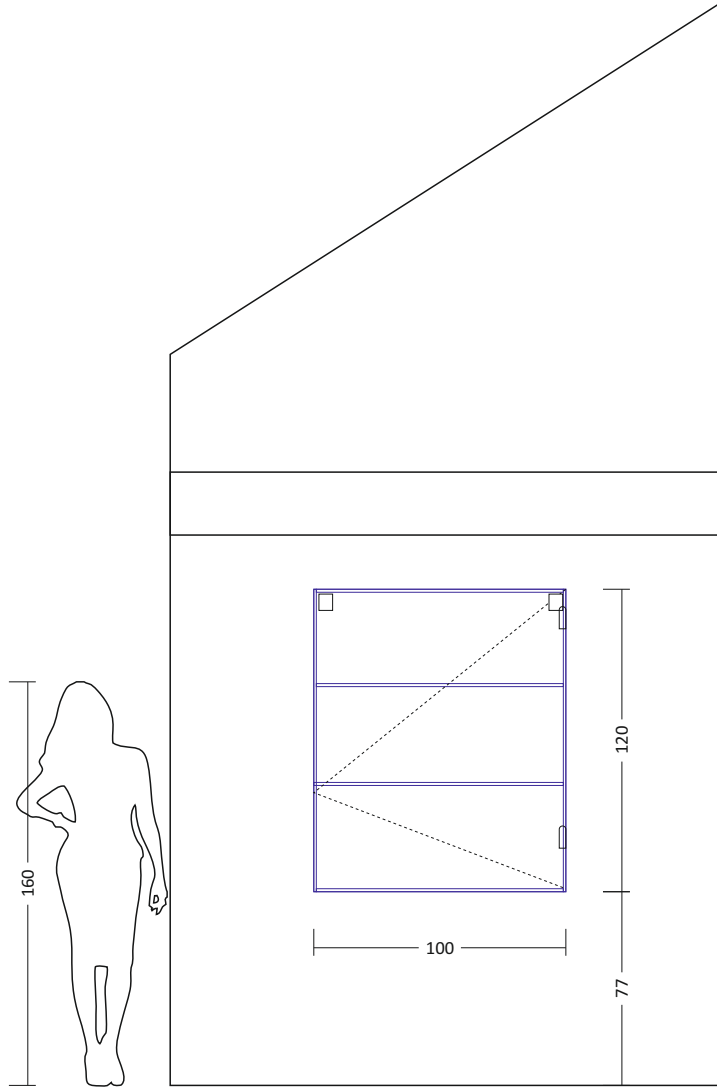

RAL 7034

RAL 4002

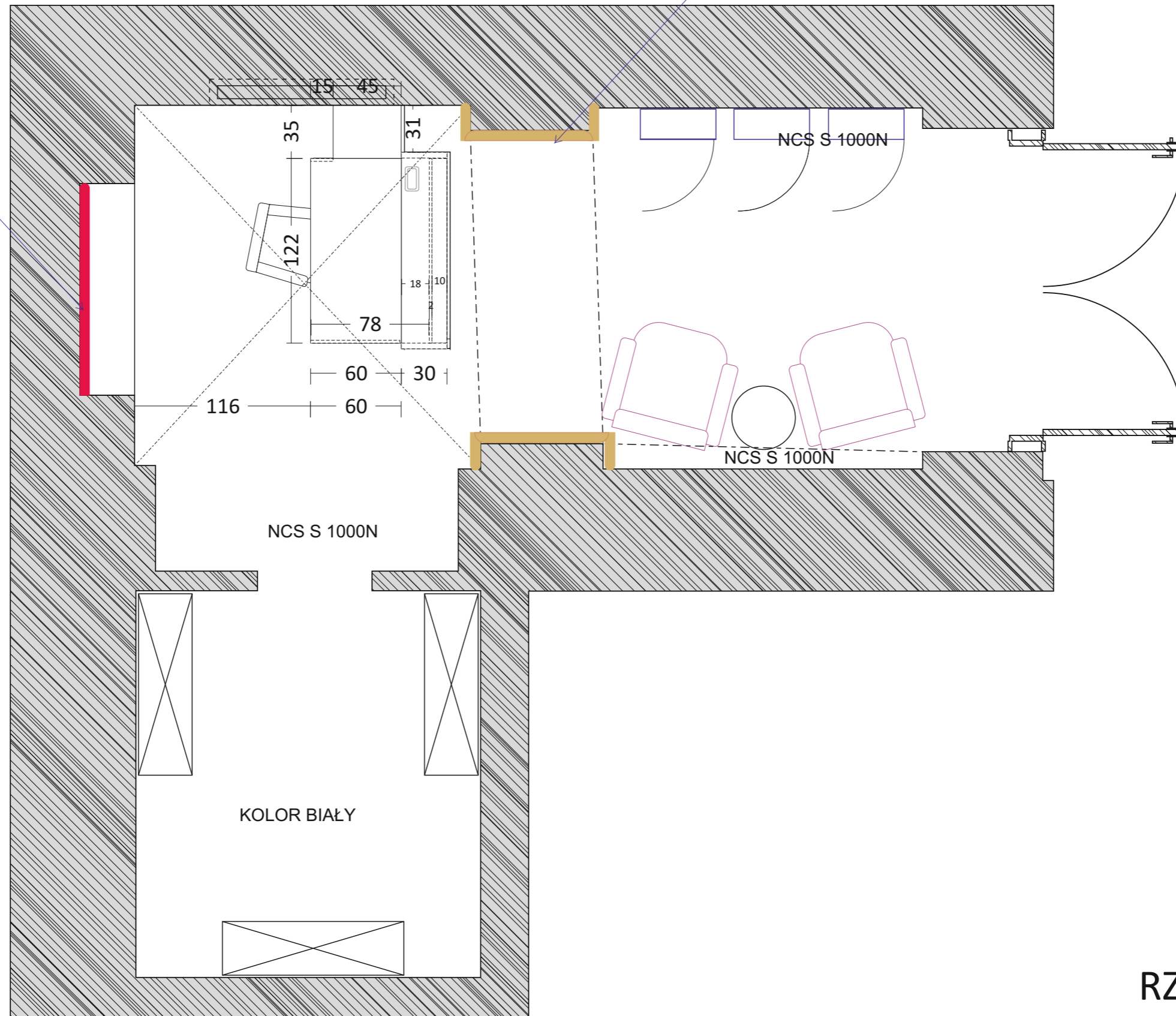

RZUT SALA - FARBY  
skala 1:30