

## 1. NYPEL JEDNOSTRONNY DO WSPAWANIA

Gwint zewnętrzny DIN 2982,  
wykonany ze stali 316 lub 304

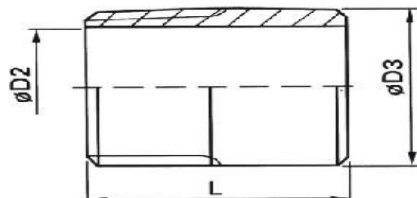

Charakterystyka:

| WYMIAR | D2 (mm) | D3 (mm) | L (mm) |
|--------|---------|---------|--------|
| 1/8"   | 6.0     | 10.2    | 30.0   |
| 1/4"   | 9.0     | 13.5    | 30.0   |
| 3/8"   | 12.0    | 17.2    | 30.0   |
| 1/2"   | 16.0    | 21.3    | 35.0   |
| 3/4"   | 21.0    | 26.9    | 40.0   |
| 1"     | 27.0    | 33.7    | 40.0   |
| 1 1/4" | 35.0    | 42.4    | 50.0   |
| 1 1/2" | 41.0    | 48.3    | 50.0   |
| 2"     | 53.0    | 60.3    | 50.0   |
| 2 1/2" | 66.0    | 76.1    | 60.0   |
| 3"     | 79.0    | 88.9    | 70.0   |
| 4"     | 103.0   | 114.3   | 80.0   |